

ARMOURPOST

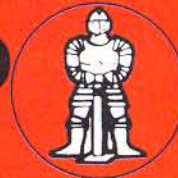

L I M I T E D

'Concertina' Folding Shutter Doors



The '**CONCERTINA**' folding shutter door is a strong and durable product and will tolerate some of the most extreme weather conditions. The folding action of the door system is smooth and easy to operate which makes the door a viable proposition for both commercial and industrial applications.

The doors are hung from the top and can be supplied in single fixed, double fixed or floating sections, which neatly stack to one or both sides of an opening depending on the door arrangement. The door unit is held in place by the bottom track which allows the door to slide freely in both the opening and closing direction.

The '**CONCERTINA**' folding shutter can be supplied manually or electrically operated dependent on your specific requirements and special fixing options are available to cater for the non standard opening arrangement.

SPECIFICATION

Construction:- The door leaves are formed from 230mm wide galvanised steel sections with rolled edges, which form the hinge action of the leaf. These slide into a patented picket section and terminate within the guide channel which the door slides within and which we refer to as the bottom track. The smooth operation of the door is achieved by the incorporation of a lattice bar frame work which allows the door to open and close evenly and freely. Attached to the door assembly is a leading edge which is fitted with pull handles, this strengthens the door and provides a platform for a locking device to be fitted.

Finish:- All rolled parts are supplied in a galvanised steel finish, other items are zinc plated with the exception of top track fixing brackets which are prime painted. Door leaves can be finished in a HP200 plastisol coating up to 6000mm in height, leaf thickness 0.9mm. Polyester powder coating is also available, however you should note that the leading edge, outer hinge strips and the outside face of the leaves only are colour finished, all other items are supplied in their standard form.

Maximum Size Range:- Height up to 6000mm as standard.
Width is unlimited with the incorporation of multiple units.

Total Weight:- 30Kg per square metre

ARMOURPOST



L I M I T E D

Typical Door Construction

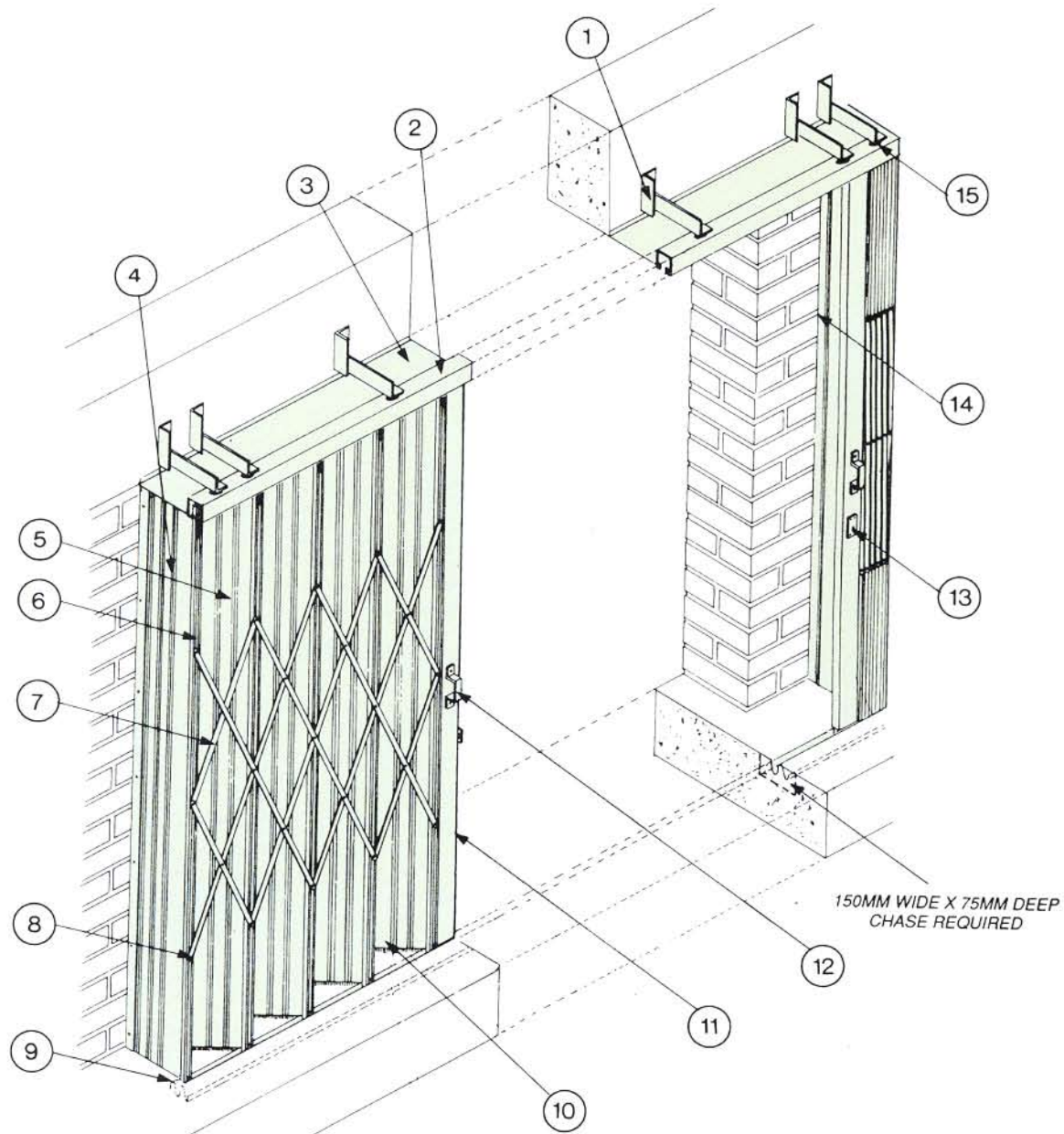

1. Top track fixing brackets, fabricated from steel angles factory prime finished.
2. Cold rolled galvanised steel top track 2.6mm or 5mm thick dependent on door size.
3. Coverplates are supplied to reduce draughts and are formed in galvanised steel.
4. End closer plates are supplied to close off gaps between the end picket and the structure we are fixing to.
5. Leaves - are cut from ribbed galvanised steel, 0.9mm or 1.2mm thick x 230mm wide complete with rolled edges which hinge within the picket and front hinge strip sections.
6. Pickets - are patented and are formed from cold rolled galvanised steel section fitted with a sealed ball bearing roller. The pickets support the weight of the shutter leaves and provide connections for the lattice assembly.
7. Lattice - frames are formed from cold rolled galvanised steel and allow the door to open and close evenly and easily by hand.
8. Lattice sliders - are special bolts with Teflon coated heads which ensure that the ends of the lattice bars and frames slide freely.
9. Bottom track - is formed from a 2mm thick galvanised steel rugged section which lends itself to grouting with its continuous lip.
10. Brush strip - nylon clip on brush seals are supplied as standard to the bottom of each shutter leaf.
11. Leading edge - is fabricated from galvanised steel, the standard width is generally 75mm but can be up to 300mm to stabilise larger doors or to accommodate cut outs for runway beams.
12. Pull handles are formed from aluminium.
13. Locking as standard is via a surface mounted hasp and staple. Clutchbolt and hookbolt locks are available at an additional cost if we are notified at the time of your enquiry.
14. Outer hinge strips - are formed from ribbed galvanised steel sections which provide a front hinge for the outer edges of the leaf pairs.
15. Packing shims - in zinc plated steel for track adjustment are supplied.